

## 2 in 1 LED Controller Kits (2.4GHz)

Model No.: FUT035SA+

### Features

- Control Distance: 30m
- Brightness and color temperature adjustable
- Switching 2 output mode via one button (Single color / Dual white)



Color temperature adjustable



Remote control  
Control distance 30m



Dim brightness



Smartphone App control  
(2.4GHz gateway is needed)



Support PUSH dimming



Support third party voice control  
(2.4GHz gateway is needed)

### Parameters

#### Remote

Operating Voltage: 3V(AAA\*2PCS)

Standby power: < 20μA

Transmit power: 6dBm

Control Signal: 2.4G Hz

Modulation Method: GFSK

Control Signal: 2.4GHz RF

Control Distance: 30M

IP Rate: IP20

Working Temp.: -10~40°C

EMC Standard (EMC): ETSI EN 301 489-1 V2.2.3  
ETSI EN 301 489-3 V2.1.1

#### Controller

Input Voltage: DC12-24V

Output Current: 12A/ Channel

Total Output Max 12A

Output Power: 144-288W

Output Type: Constant Voltage

Safety Standard (LVD) : EN 61347-1: 2015+A1: 2021  
EN 61347-2-11: 2001+A1:2019

Radio Equipment (RED) : ETSI EN 300 440 V2.2.1

Certification: CE, EMC, LVD, RED

Warranty: 5 Years

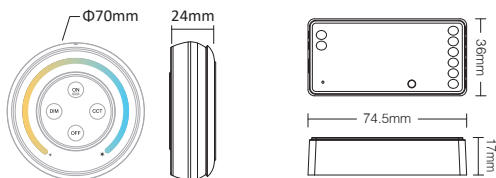

## Size

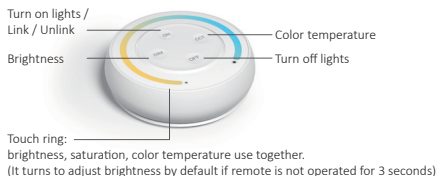

## Function



## Remote Instruction

- Adjust color temperature  
Short press CCT key once, then touch  to adjust color temperature.
- Adjust brightness  
Short press Dim key once, then touch  to adjust brightness.

## Install The Battery For Remote

Note: 2\*AAA Battery need to buy seperately



1. Open battery cover behind remote.



2. Install battery correctly and close battery cover.

## Connection Diagram

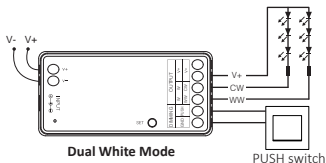
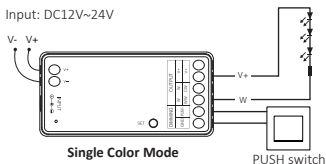

## Set up output mode

Set up correct output mode based on the feature of lights

Setting method: Press "SET" button continuously to switch output mode (attention: it will log out without operation within 3 seconds)

Output mode sheet ( confirm output mode based on color of indicator)

Indicator color	Red Light	Green Light
Output	Single color	Dual white

## Linking Code / Unlinking Code Instructions

Attention: No need to match code since its already matched code in factory setting

### Linking Code Instructions

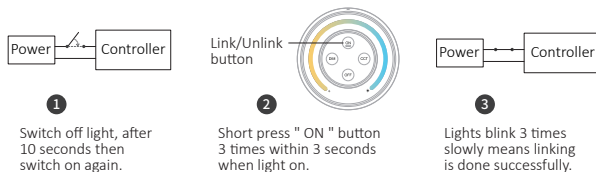

Linking failed if light is not blinking slowly, Please follow above steps again.  
(Note: Light that have linked can't link again)

### Unlinking Code Instructions

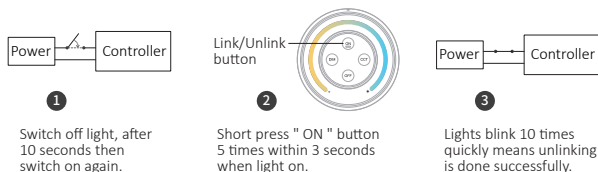

Unlinking failed if light is not blinking quickly, Please follow above steps again.  
(Note: Light haven't linked that don't need to unlink)

## Auto transmitting & Synchronization (only for remote control)

### Remote signal auto transmitting

One light can transmit the signals from the remote control to another light within 30m, as long as there is a light within 30m, the remote control distance can be limitless.

### Dynamic modes auto synchronization

Multi lights can synchronize if they are in same dynamic mode and linked with same remote (distance between each light is within 30m)

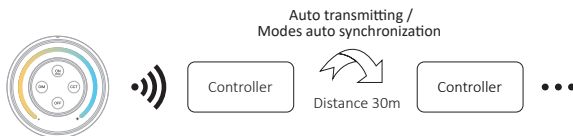

## Turn Do Not Disturb mode on and off (ON by default)

Turn on "Do Not Disturb" (applicable to areas with frequent power outages to save energy)

### Turn on Do Not Disturb mode:

Short press the "OFF" button 3 times within 3 seconds, and then short press the "ON" button 3 times. The light flashes 4 times to indicate success.

**Note:** When the lamp is powered on again after a power outage, its status (lights on or off) will remain the same as before the power outage.

### Turn off Do Not Disturb mode:

Short press the "ON" button 3 times within 3 seconds, and then short press the "OFF" button 3 times. The light flashes 4 times slowly to indicate successful shutdown.

**Note:** When the lamp is powered on again after a power outage, its status will be on by default.

## Attention

1. Please turn off power supply before installation.
2. Please ensure input voltage to be same as requirements from device.
3. Don't disassemble device if you are not expert, otherwise it will damage it.
4. Please do not use the light in the place with widely range metal area or strong electromagnetic wave nearby, otherwise, the remote distance will be seriously affected.

Made in China



Remote & Controller can not use in humid area